

Congratulations on your purchase of your Bromic Waterboy submersible Vortex sump pump.

This manual contains essential information on the installation, operation and maintenance of the pump. Please read it thoroughly and follow these instructions in order to install and use the pump correctly. Failure to follow these instructions may result in motor overcharging and other malfunctions. Bromic is not liable should instructions not have been followed.

### Specification

1. Maximum operating depth 5m below water level;
2. Continuous duty when fluid temperature under +40°C;
3. Value of PH in fluid 4-10;
4. Maximum kinematic viscosity:  $7 \times 10^{-7} - 23 \times 10^{-6} \text{ m}^2/\text{s}$ ;
5. Maximum density:  $1.2 \times 10^3 \text{ kg/m}^3$

### Technical data (the data will be some change under different voltage and frequency)

Model	Power Input (kw)	Discharge (mm)	Voltage / Frequency (V/hz)	Max Flow (L/min)	Max Head (m)	Max. Suspended Solid (mm)	Weight (kg)	Packing (cm) H x W x D
7575155	1.1	50	220-240/50	300	10	Φ25	20	54x26.5x19.5

### Performance Curve

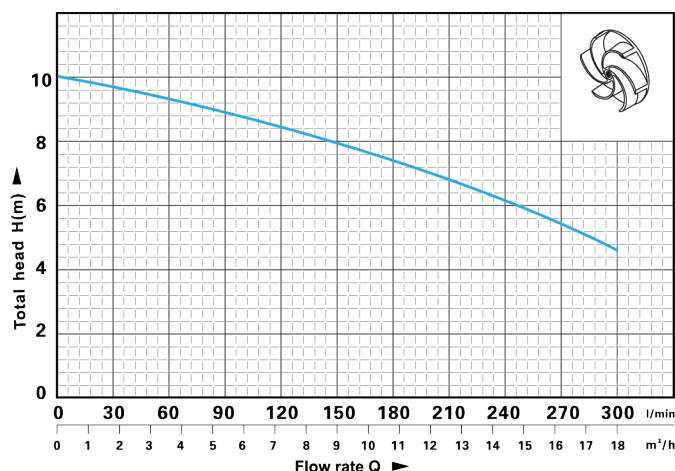

### Circuit Diagram

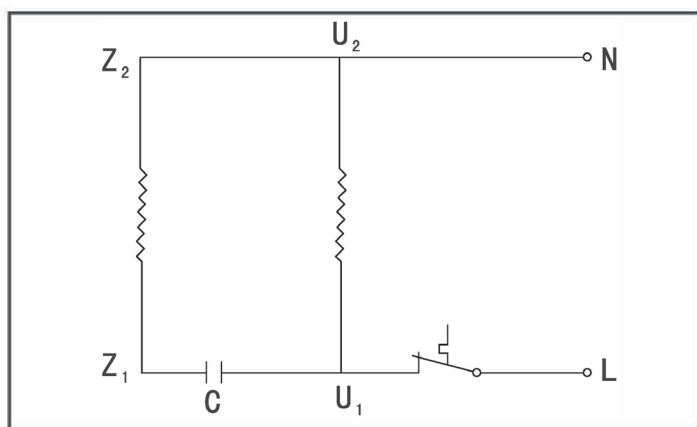

### Part View

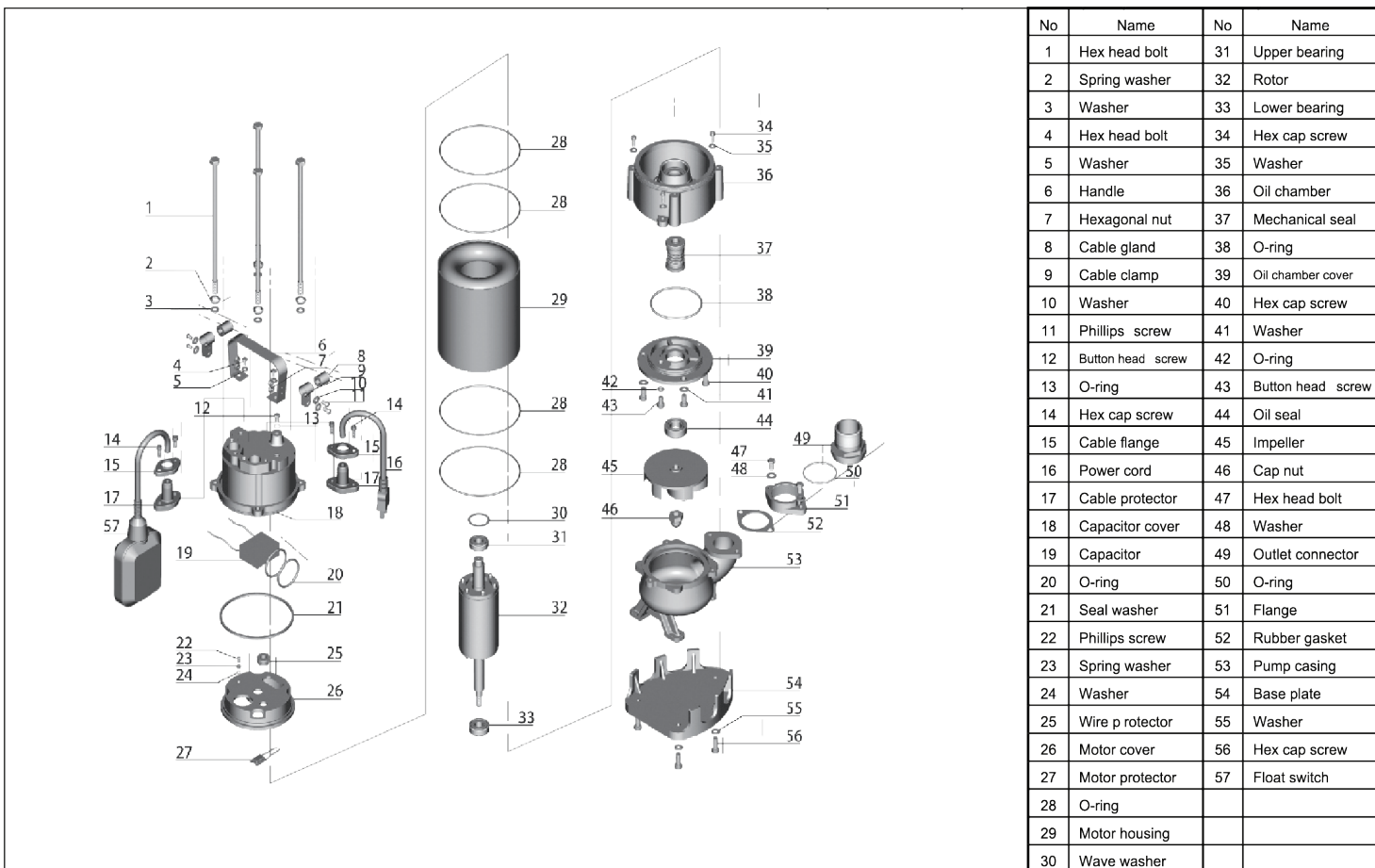

No	Name	No	Name
1	Hex head bolt	31	Upper bearing
2	Spring washer	32	Rotor
3	Washer	33	Lower bearing
4	Hex head bolt	34	Hex cap screw
5	Washer	35	Washer
6	Handle	36	Oil chamber
7	Hexagonal nut	37	Mechanical seal
8	Cable gland	38	O-ring
9	Cable clamp	39	Oil chamber cover
10	Washer	40	Hex cap screw
11	Phillips screw	41	Washer
12	Button head screw	42	O-ring
13	O-ring	43	Button head screw
14	Hex cap screw	44	Oil seal
15	Cable flange	45	Impeller
16	Power cord	46	Cap nut
17	Cable protector	47	Hex head bolt
18	Capacitor cover	48	Washer
19	Capacitor	49	Outlet connector
20	O-ring	50	O-ring
21	Seal washer	51	Flange
22	Phillips screw	52	Rubber gasket
23	Spring washer	53	Pump casing
24	Washer	54	Base plate
25	Wire p retector	55	Washer
26	Motor cover	56	Hex cap screw
27	Motor protector	57	Float switch
28	O-ring		
29	Motor housing		
30	Wave washer		

## Installation Guidelines

This appliance is not intended for use by persons (including children) with reduced physical, sensory or mental capabilities, or lack of experience and knowledge, unless they have been given supervision or instruction concerning use of the appliance by a person responsible for their safety. Children should be supervised to ensure that they do not play with the appliance.

1. Before installation, carefully check whether there is physical damage on any part of the pump including electrical cable and plug. Contact the seller if damage is found.
2. Ensure the pump is disconnected from the power source before performing any procedure (handling, inspection, installation, etc.). Allow the pump surface to cool to ambient temperature by waiting for at least 30 minutes.
3. Ensure the site's power supply meets requirement as stated on the rating label. Pump must be earthed.
4. Ensure fittings and joints are watertight.
5. Tie a rope on the handle to move the pump up and down. Never drag the electrical cable as it may cause electrical hazard.
6. The power supply connected to the pump must be protected by RCD or other protective device according to Australian standard and regulations.
7. Do not touch or move the pump before disconnecting it from the power supply.
8. Ensure all electrical connection is away from water or area subject to flooding.
9. If the pump is idle for a long period of time, it must be removed, cleaned and stored in a dry & cool place.
10. The pump must be installed by a qualified technician.

### Notes:

- The maximum immersion depth of the pump is 5m
- Pollution of the liquid could occur due to leakage of lubricants
- A protective device (RCD) must be installed with pump (residual operating current <30mA)











## Warranty

Please visit our webpage for warranty details- (<https://www.bromicplumbing.com/warranty-information/>)  
Read all relevant documentation before operating the pump.  
Failure to follow instructions may result in warranty being voided

## Troubleshooting

Fault	Possible Cause	Solutions
The motor does not start	No or incorrect power supply	Ensure power supply is as per rating label
	Fuse or thermal relay disconnected	Consult service provider
Flow is insufficient	Water inlet blocked	Remove blockage
	Total manometric head higher than expected	Verify geometric head and reposition
	Discharge pipe not joined properly	Check the joint, ensure there is no leak
	Source water level is low	Reposition pump or stop pumping
	Impeller is worn out or blocked	Try to remove the blockage or contact dealer
Others		Consult service provider

## Warnings

-  Danger: Keep the pump equipment away from children.
-  Danger: Do not operate the pump in locations classified as hazardous.
-  Warning: The pump is designed to handle soft particles no larger than 25mm in diameter. Larger particles may cause permanent damage.
-  Warning: The pump is designed for water only, used on chemicals or corrosive liquid will damage the pump and void warranty.
-  Warning: Do not use the pump for liquid exceeding 40°C.
-  Warning: Never run the pump dry, dry operation will permanently damage the pump and void the warranty
-  If the supply cord is damaged, it must be replaced by the manufacturer, its service agent or similarly qualified persons in order to avoid a hazard
-  The pump must not be used when people are in the water
-  The pump must be supplied through a residual current device (RCD) having a rated residual operating current not exceeding 30mA
-  Disconnect the pump from the supply mains before carrying out user maintenance such as cleaning the filter

## Cleaning the Appliance Externally

Rinse with clean water. Remove stubborn contamination with a brush and detergent, then rinse with clean water. Submerge the pump in a container with clean water and switch on for a short time to rinse the inside of the pump.

## Cleaning the Suction Area

Clean all accessible insides of the casing. Remove fibres which have wound around the rotor shaft by opening the pressure connection. Remove stubborn contamination with a brush and detergent, then rinse with clean water.

**WATERBOY™**

Better with **BROMIC**  
PLUMBING & GAS

**BROMIC Pty Ltd**

**10 Phiney Place, Ingleburn, NSW 2565 Australia**

**AU 1300 276 642 NZ 0508 276 642 E [plumbing@bromic.com](mailto:plumbing@bromic.com) W [bromicplumbing.com](http://bromicplumbing.com)**